

PORTER SUBDIVISION (PHASE 2) TREE INVENTORY									
CLOSEST MN	ID NUMBER	COMMON NAME	LATIN NAME	TRUNK Ø (cm)	CANOPY Ø (m)	COMMENTS / CONDITION / ISSUES	OWNERSHIP	RECOMMENDED ACTION	DECIDED ACTION
Ross 213	RS071	Norway Maple	Acer platanoides	50	12	9/10 - girdled roots	Private		
Ross 213	RS072	Silver Maple	Acer saccharinum	100	16	major included bark at main union with decay pockets present - either remove southern most main leader over yard, or remove all together	Shared	Review at time of construction	Review at time of construction
Ross 213	RS073	Norway Maple	Acer platanoides	10	6		Shared		
Ross 213	RS074	Norway Maple	Acer platanoides	10	6		Shared		
Ross 213	RS075	Siberian Elm	Ulmus pumila	40	10	Siberian Elm cluster - all stems have major basal defects & included bark at almost every main union - heavy outer growth will cause failure	Shared	REMOVAL	REMOVAL
Ross 213	RS076	Siberian Elm	Ulmus pumila	110	17	Siberian Elm cluster - all stems have major basal defects & included bark at almost every main union - heavy outer growth will cause failure	Shared	REMOVAL	REMOVAL
Ross 179	RS077	Blue Spruce	Picea pungens	10	3	Cytospora Canker & Rhizosphaera needle cast	Shared		
Ross 179	RS078	Blue Spruce	Picea pungens	10	3	Cytospora Canker & Rhizosphaera needle cast	Municipal		
Ross 179	RS079		SHRUBS				Shared		
Ross 185	RS080	Silver Maple	Acer saccharinum	90	15	10/10 - canopy 5/10 - structure - major included bark & hollows at main unions	Private	recommend REMOVAL to homeowner	removal by others
Ross 220	RS081	White Cedar	Thuja occidentalis	30	8		Shared		
Ross 220	RS082	White Cedar	Thuja occidentalis	30	8		Shared		
Ross 220	RS083	White Cedar	Thuja occidentalis	30	8		Shared		
Ross 220	RS084	White Cedar	Thuja occidentalis	40	10	8/10 - slight thinning	Shared		
Ross 221	RS085	Sugar Maple	Acer saccharum	50	11	9/10 - minor included bark	Shared		
Ross 221	RS086	White Cedar	Thuja occidentalis	HEEDGE	HEEDGE		Shared		
Ross 219	RS087	Crimson Maple	Acer platanoides	40	12		Municipal		
Ross 219	RS088	Crimson Maple	Acer platanoides	60	14		Municipal		
Ross 219	RS089	Common Maple	Acer platanoides	40	10		Municipal		

PORTER SUBDIVISION (PHASE 2) TREE INVENTORY									
CLOSEST MN	ID NUMBER	COMMON NAME	LATIN NAME	TRUNK Ø (cm)	CANOPY Ø (m)	COMMENTS / CONDITION / ISSUES	OWNERSHIP	RECOMMENDED ACTION	DECIDED ACTION
Ruth 213	RU001	White Cedar	Thuja occidentalis	30	6		Shared		
Ruth 213	RU002	Eastern White Spruce	Picea glauca	20	6		Shared		
Ruth 213	RU003	Norway Spruce	Picea abies	25	6		Shared		
Ruth 213	RU004	White Cedar	Thuja occidentalis	HEEDGE	HEEDGE		Shared		
Ruth 217	RU005	Knotted Cypress	Cupressus noodkatensis	15	6		Shared		
Ruth 217	RU006	White Cedar	Thuja occidentalis	HEEDGE	HEEDGE		Shared		
Ruth 221	RU007	Native Red Maple	Acer rubrum	50	16	9/10 - thinning	Private		
Ruth 220	RU008	White Cedar	Thuja occidentalis	40	10		Shared		
Ruth 2012	RU009	White Cedar	Thuja occidentalis	50	9		Shared		

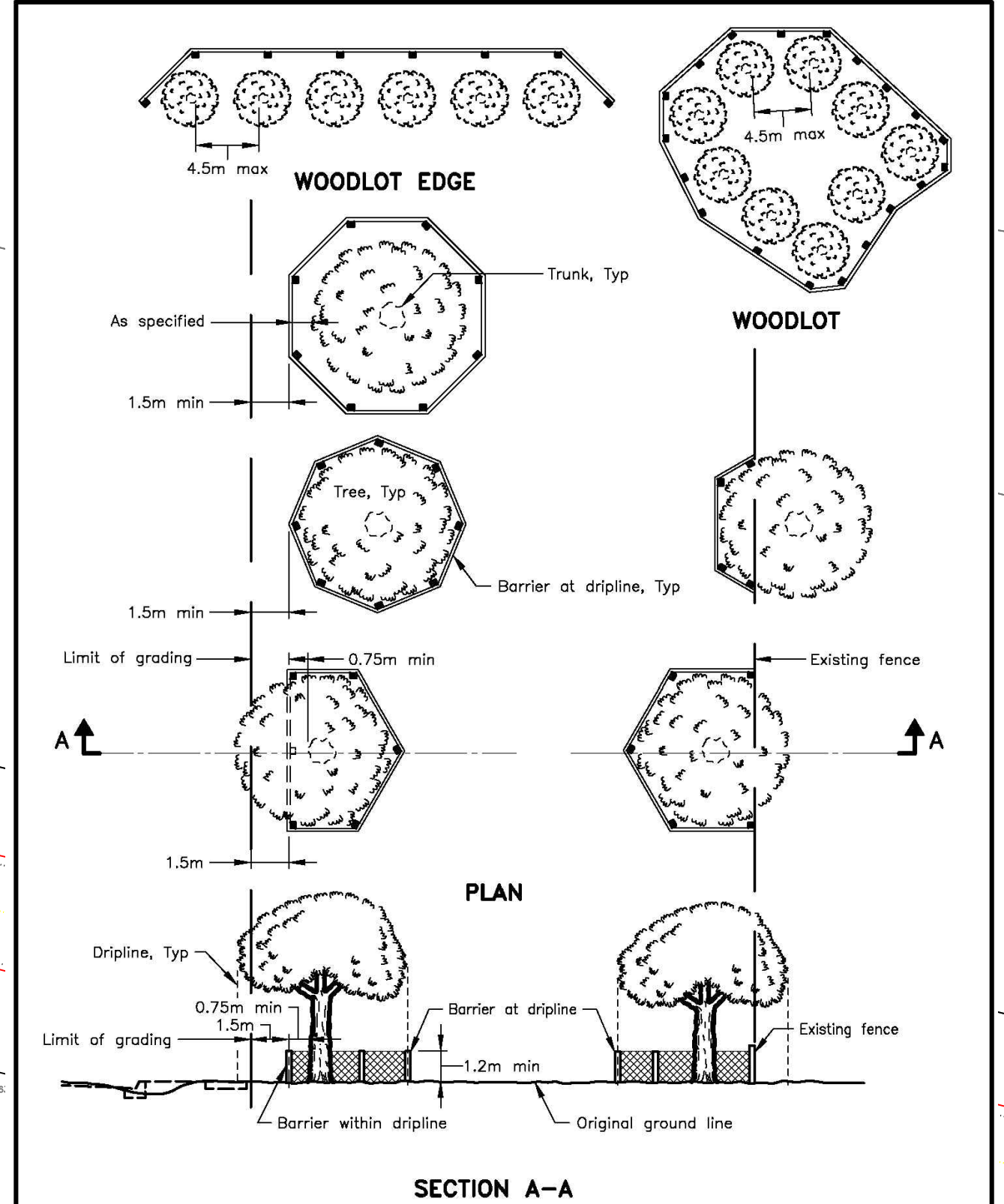
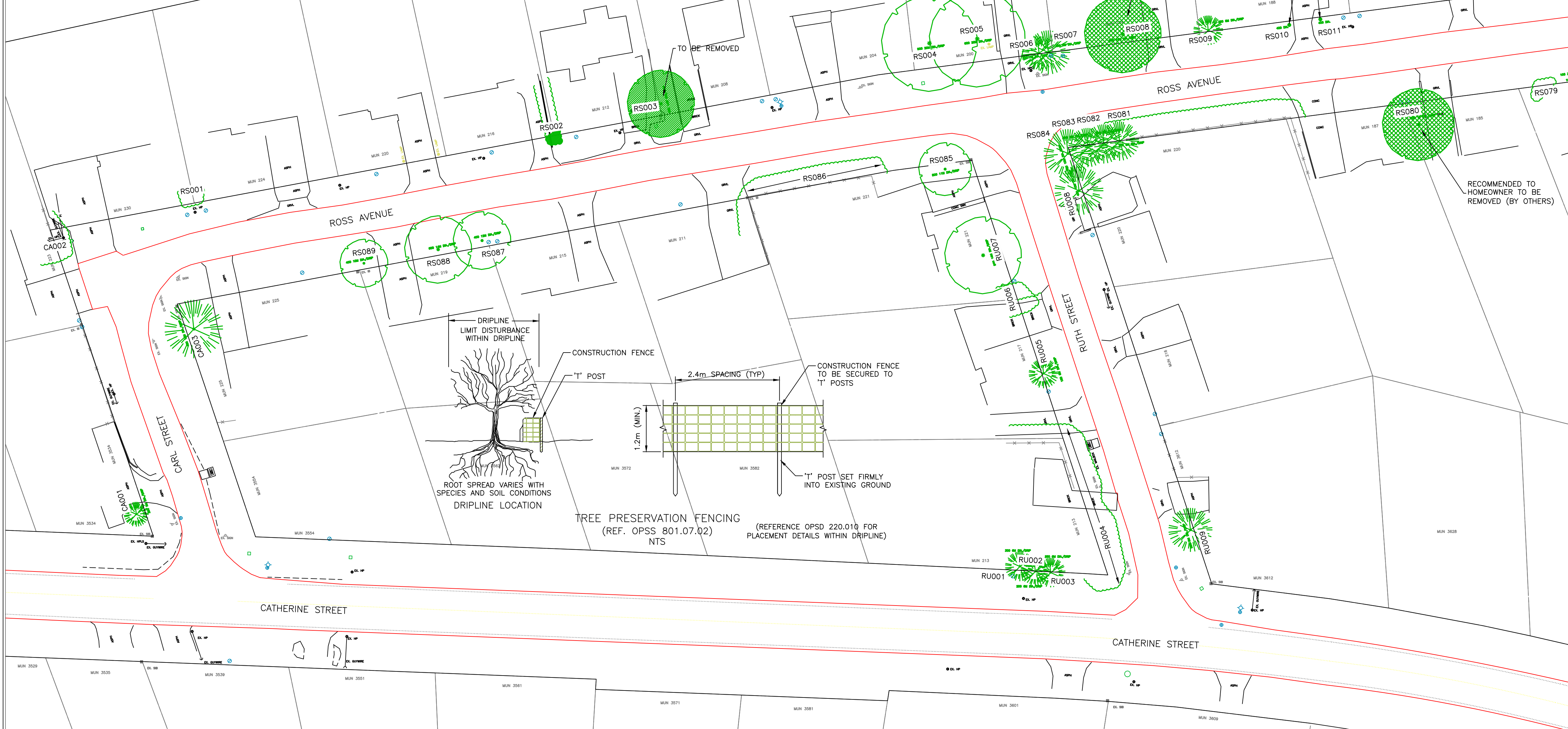

PORTER SUBDIVISION (PHASE 2) TREE INVENTORY									
CLOSEST MN	ID NUMBER	COMMON NAME	LATIN NAME	TRUNK Ø (cm)	CANOPY Ø (m)	COMMENTS / CONDITION / ISSUES	OWNERSHIP	RECOMMENDED ACTION	DECIDED ACTION
Carl 3534	CA001	Black Cedar	Thuja occidentalis	25	5		Private		
Carl 223	CA002	Black Cedar	Thuja occidentalis	HEEDGE	HEEDGE		Shared		
Carl 225	CA003	White Pine	Pinus strobus	45	12		Private		
Ross 230	RS001	Black Cedar	Thuja occidentalis	HEEDGE	HEEDGE		Private		
Ross 212	RS002	Black Cedar	Thuja occidentalis	HEEDGE	HEEDGE		Shared		
Ross 202	RS003	Sugar Maple	Acer saccharum	65	14	7/10 - thinning crown on west side	Private	REMOVAL	REMOVAL
Ross 200	RS004	Silver Maple	Acer saccharinum	90	20	8/10 - included bark & main union	Private		
Ross 200	RS005	Sugar Maple	Acer saccharum	60	20	8/10 - included bark & main union	Private		
Ross 200	RS006	White Pine	Pinus strobus	30	7	8/10 - thinning	Shared		
Ross 200	RS007	White Pine	Pinus strobus	45	9	10/10	Shared		
Ross 194	RS008	Manitoba Maple	Acer negundo	50	16	4/10 - dieback & thin canopy	Private	recommend REMOVAL to homeowner	removal by others
Ross 188	RS009	White Cedar	Thuja occidentalis	35	6		Shared		
Ross 188	RS010	White Cedar	Thuja occidentalis	40	6	9/10 - thinning top	Municipal	Thames Centre to remove tree. Contractor to remove stump	
Ross 188	RS011	White Cedar	Thuja occidentalis	40	6		Municipal	Thames Centre to remove tree. Contractor to remove stump	
Ross 184	RS012	Tulip Tree	Liriodendron	15	4	10/10 - multi stem, no liability	Private		
Ross 176	RS013	Blue Spruce	Picea pungens	SHRUB	SHRUB		Shared		
Ross 172	RS014	Sand Cherry	Prunus pumila	15	10/10		Shared		
Ross 168	RS015	Paper Bark Maple	Acer griseum	20	4	10/10 - health - structure	Shared		

EXISTING SERVICES	DRAWING #, SOURCE	DATE	AS CONSTRUCTED SERVICES	COMPLETION	DETAILS	No.	REVISIONS	DATE	CONSULTANT
					DESIGN BY RAB DRAWN BY RAB CHECKED BY JS F.B.K. ***	1	PUM PRESENTATION	???	DEVENG

CONSULTANT OR DIVISION	ENGINEER'S STAMP
London Office 41 Adelaide St. N., Unit 71 (519) 672-8310	
Paris Office 31 Mechanic St., Unit 301 (519) 442-1441	

SCALE: 1:500
5 0 10m

TITLE: PORTER SUBDIVISION WATERMAIN REPLACEMENT AND ROAD RECONSTRUCTION - PHASE 2, DORCHESTER, ON

PROJECT No. DEL20-003B
SHEET No. 26
PLAN FILE No.

ONTARIO PROVINCIAL STANDARD DRAWING Nov 2019 Rev 1

BARRIER FOR TREE PROTECTION

OPSD 220.010

FILE: DEL20-003 TREE B PUM.DWG

DEL20-003 TREE B PUM.DWG
 2024-01-17 11:23:11 0:59am
 borlett Mar 17 23:11 0:59am