

PORTER SUBDIVISION WATERMAIN REPLACEMENT AND ROAD RECONSTRUCTION

DORCHESTER, ONTARIO



CONSULTING CIVIL ENGINEERS



CONTACT INFORMATION

ENGINEERING CONSULTANT

Development Engineering (London) Limited

41 Adelaide St. N, Unit 71, London, ON, N6B 3P4

Josh Smith, P.Eng.

Project Manager

jsmith@deveng.net

519-672-8310 x113

Daniil Lobastov

Contract Administrator

dlobastov@deveng.net

519-672-8310 x139

MUNICIPALITY OF THAMES CENTRE

4305 Hamilton Road, Dorchester, ON, N0L 1G3

Jarrold Craven

Director of Public Works

jcraven@thamescentre.on.ca

519-268-7334 x245

Tanner Stanton

Engineering Technologist

tstanton@thamescentre.on.ca

519-268-7334 x235

PROJECT LOCATION

PORTER SUBDIVISION WATERMAIN
REPLACEMENT AND ROAD
RECONSTRUCTION

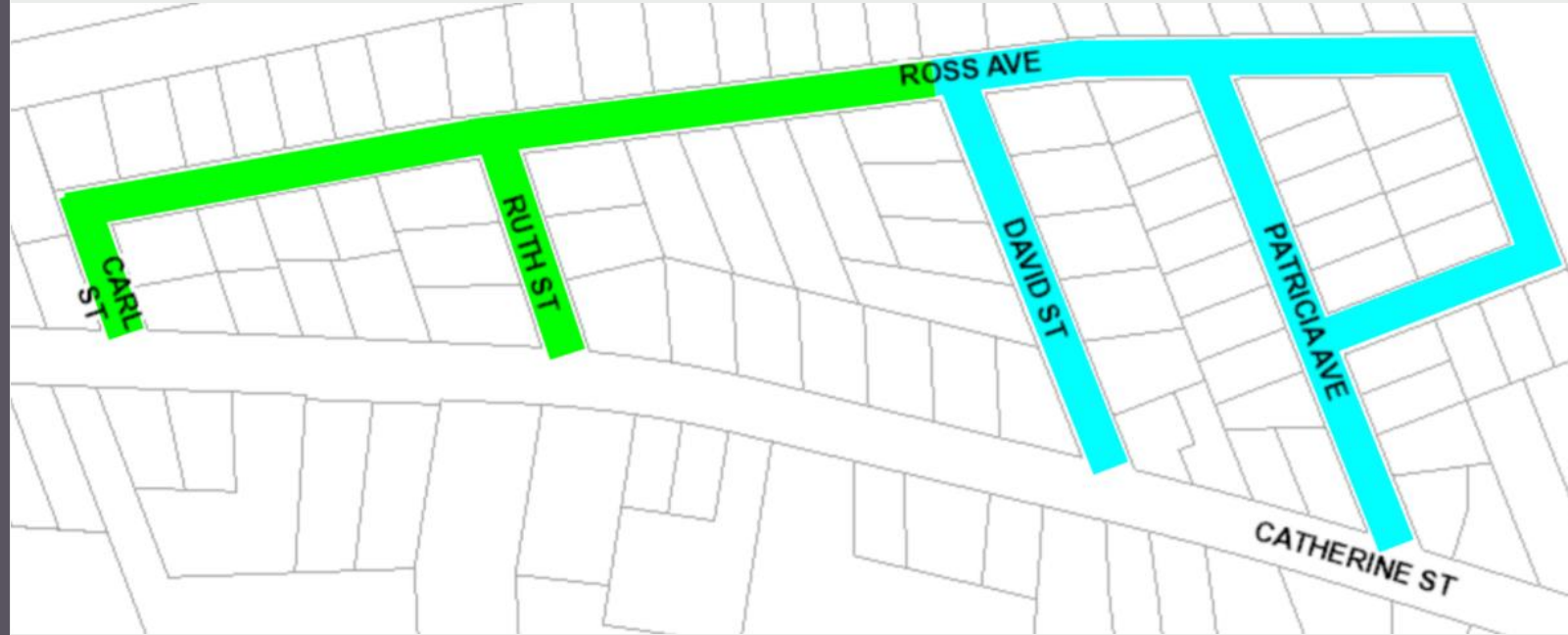

PHASE 2

PHASE 1

WHAT WORK IS GOING TO BE DONE?

- **Replacing storm sewers with new storm sewers and catchbasins**
- **Provide storm PDCs (Private Drain Connections) for existing or future connection of sump pump discharge**
- **Replace watermains, water services to property line, new fire hydrants**
- **Surface works including addition of curb and gutter, sidewalks, new asphalt, driveway replacement to property line, boulevard regrading**
- **The project will be split into two construction phases**

WHEN WILL CONSTRUCTION OCCUR?

- **Construction for Phase 1 is anticipated to commence in July 2022.**
- **Construction of this Phase is anticipated to be generally complete by mid-December 2022, however minor construction work will occur the following year such as replacement of any curb or sidewalk that may crack over the winter and application of the second (top) layer of asphalt.**
- **Construction for Phase 2 will be in the future and is tentatively scheduled for 2023**

PROJECT PHASING DRAWINGS

PHASE 1

David Street, Patricia Ave, and Ross Ave to David Street

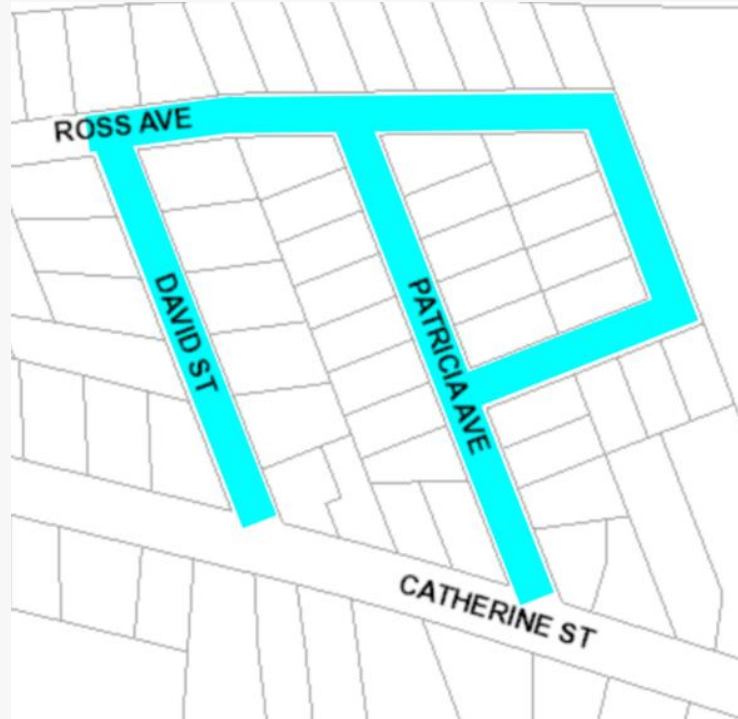

PHASE 2

Carl Street, Ruth Street, and the remainder of Ross Ave



TYPICAL DRAWING OF SEWER AND WATER PIPE CONSTRUCTION



PORTER SUBDIVISION WATERMAIN
REPLACEMENT AND ROAD
RECONSTRUCTION

TYPICAL DRAWING OF SEWER AND WATER PIPE CONSTRUCTION



PORTER SUBDIVISION WATERMAIN
REPLACEMENT AND ROAD
RECONSTRUCTION

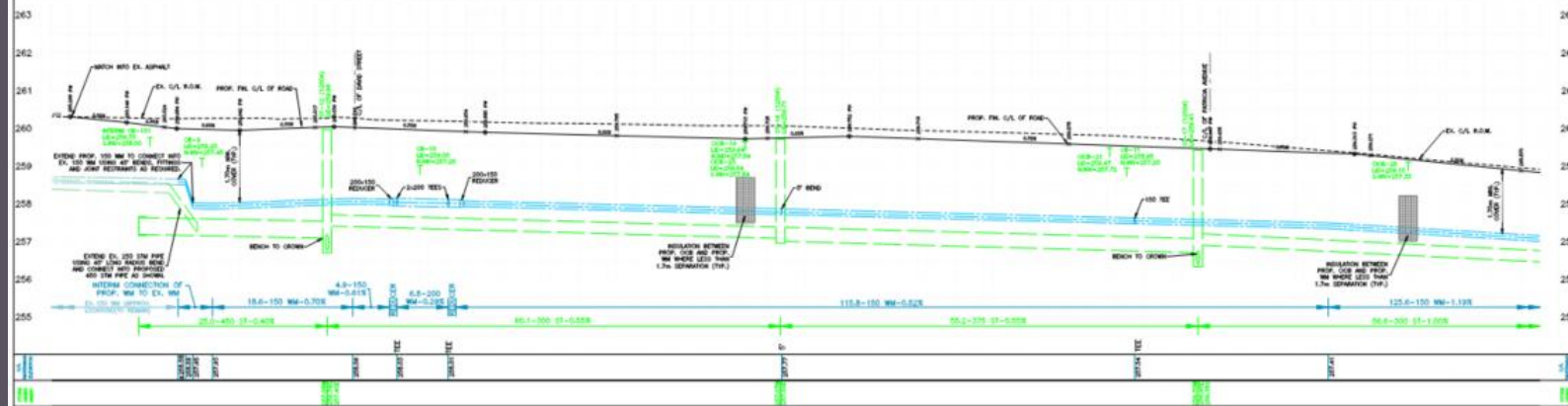
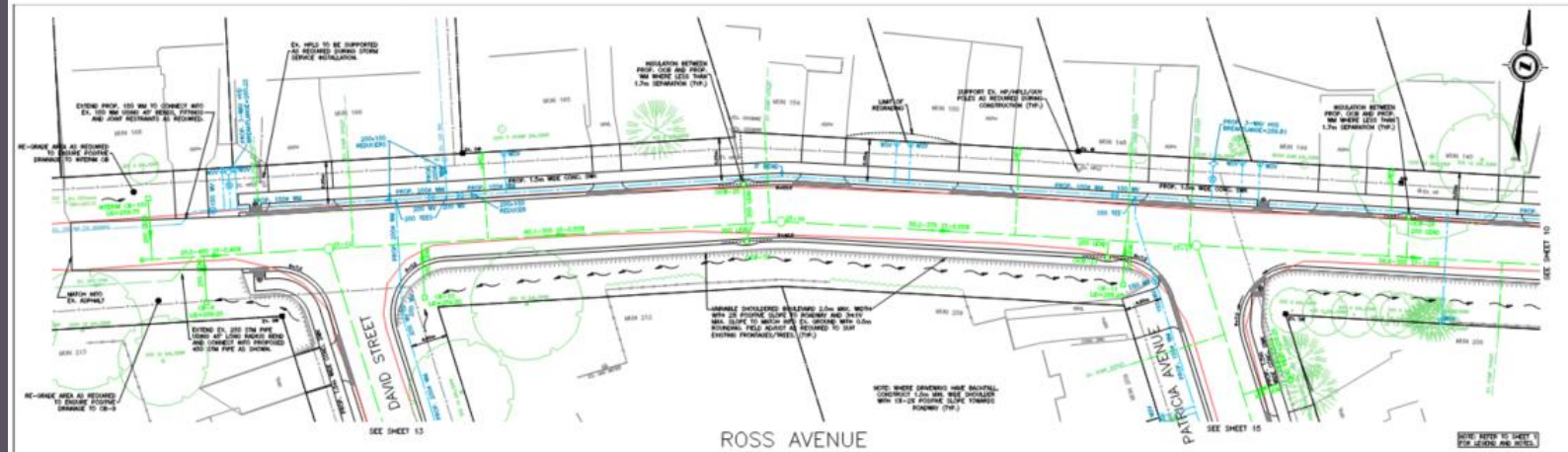

NO.	REVISION	DATE	BY	CHECKED	APP'D
1	ISSUED FOR TENDERS	20/10/20	JM	SM	SM
2	REVISED FOR COMMENTS	20/10/20	JM	SM	SM
3	REVISED FOR COMMENTS	20/10/20	JM	SM	SM
4	REVISED FOR COMMENTS	20/10/20	JM	SM	SM
5	REVISED FOR COMMENTS	20/10/20	JM	SM	SM

<p>development engineering CONSULTING CIVIL ENGINEERS</p>	<p>Thames Centre</p>	<p>PORTER SUBDIVISION WATERMAIN REPLACEMENT AND ROAD RECONSTRUCTION, DORCHESTER, ON</p> <p>PROPOSED CONSTRUCTION ROSS AVENUE FROM 40m WEST OF DAVID STREET TO 45m EAST OF PATRICIA AVENUE</p>	<p>SCALE HORIZONTAL - 1:500 VERTICAL - 5:1</p>	<p>PROJECT NO. DEL20-003A SHEET NO. 9</p>
---	----------------------	---	--	---

EXAMPLE ROADWAY DRAWING 1

PORTER SUBDIVISION WATERMAIN
REPLACEMENT AND ROAD
RECONSTRUCTION

TYPICAL NEW SERVICES CROSS SECTION

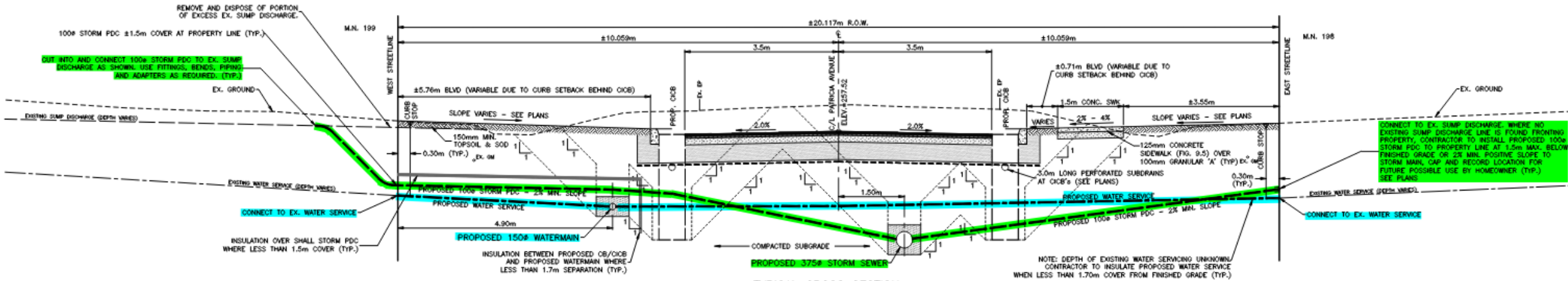

TYPICAL CROSS SECTION
PATRICIA AVENUE
(SIMILAR TO ±0+185)

WHO IS RESPONSIBLE?

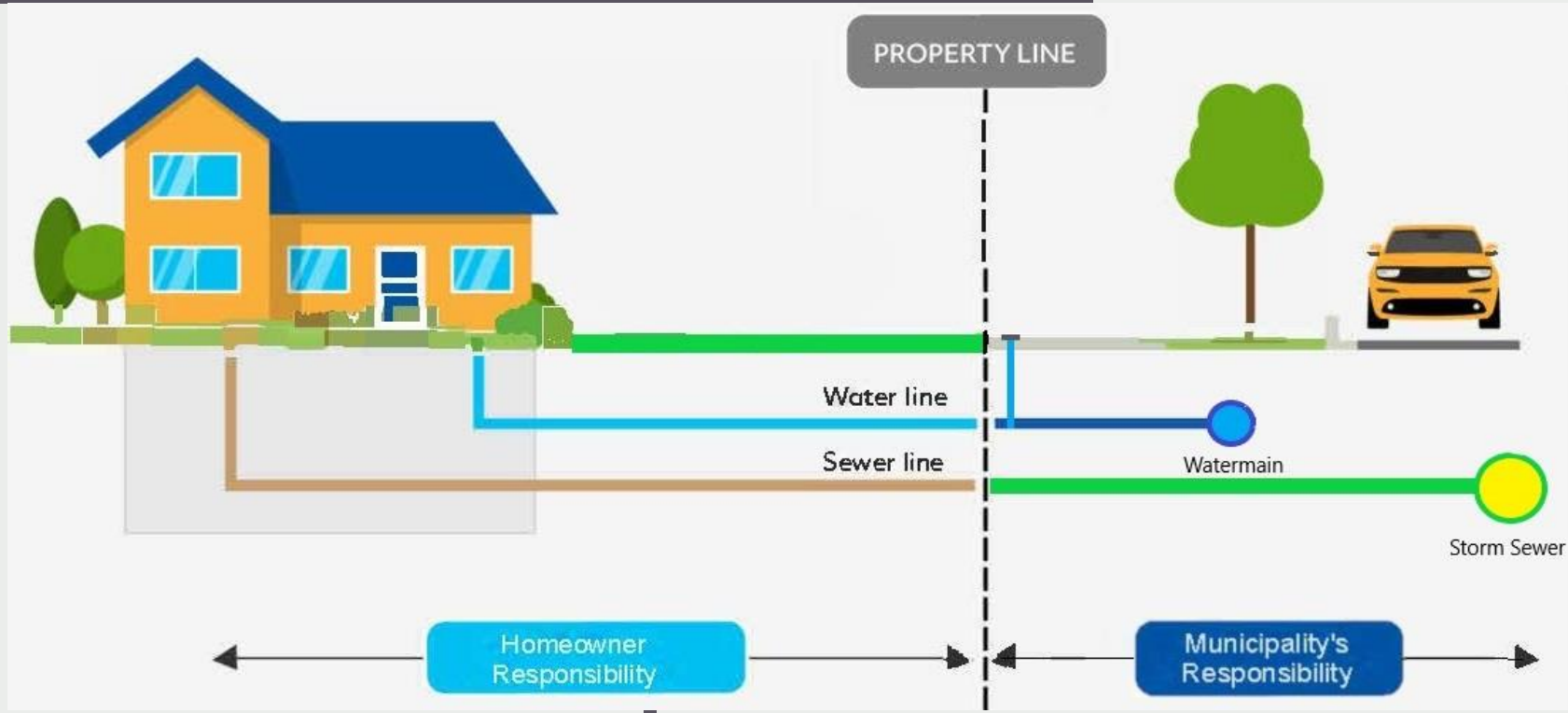

PORTER SUBDIVISION WATERMAIN
REPLACEMENT AND ROAD
RECONSTRUCTION

HOW MUCH IS THIS PROJECT GOING TO COST ME?

- **This project comes at no charge to homeowners**
- **All infrastructure is being replaced/ upgraded up to your property line at the Municipality's expense. The existing infrastructure is nearing end of life and is due to be replaced**

WHY IS THERE SIDEWALKS BEING INSTALLED?

- **When infrastructure is at the end of its life, the Municipality, whenever possible, will take the opportunity to upgrade a road within the Urban Settlement Area to bring the roadway up to urban standards (storm sewers, curb and gutter, sidewalks, etc.)**
- **Sidewalks provide upgraded safety for pedestrians and reduce the likelihood of pedestrian crashes**
- **Sidewalks increase mobility and helps provide overall healthier communities**

HOW WILL MY PROPERTY CONNECT TO THE NEW INFRASTRUCTURE?

- **Water services:** Water services will be replaced from the new watermain in the street to the property line and be connected to the existing water service
- **Storm services:** New storm private drain connections will be installed to the property line and connected to the existing PDC/ sump pump outlet (if one exists)
- **The above service replacements are at no cost to the property owner**
- **Once construction is completed, property owners can hook up to the new sewer connections by applying for a building permit on the Municipality's website, if a connection did not previously exist.**

WILL THERE BE ANY VISUAL CHANGES TO THE ROADWAY?

- **Concrete curb and gutter and sidewalk will be added**
- **Road surface will be replaced**
- **Boulevards will be regraded eliminating the ditches in many areas**
- **Restoration of driveways and walkways affected by construction**
- **Restoration of grass and soil disturbed by construction**
- **Protection of trees where possible, some tree removals are required**

GARBAGE AND RECYCLING COLLECTION

- **How will my garbage and recycling be collected during construction?**
- **Put out your garbage and recycling as per normal practice**
- **The construction contractor will collect the bags/containers and transport them to a designated location (edge of project limits) for collection by the Municipality's waste services.**
- **At the end of the day, the contractor will return containers to the appropriate properties**
- **Helpful hint: Label your municipal number on any containers with a permanent marker**

ROADWAY IMPACTS

- **Roads will be closed but remain passable for local traffic and emergency vehicles during construction.**
- **Access interruptions during excavation and surface works such as curb and sidewalk construction will be communicated to the residents in advance.**

DRIVEWAY IMPACTS

- **Driveways that are disturbed will be restored**
- **Driveway restorations will be with like material**
- **Brick driveways will have the bricks stored and then reinstalled**
- **Throughout the construction process, residents will have access to their driveways, however there will be instances where access may be limited. An example would be if the sidewalk concrete was just poured and time is needed for it to cure, or if significant digging is occurring within the roadway in front of the driveway.**
- **Homeowners will be given notice to any disruption to their driveway access**

COMMUNITY MAILBOXES

- **Community mailboxes are to be temporarily relocated by Canada Post and may require temporary pick up at the local Post Office, or at a temporary location for the community mailbox**
- **Permanent mailbox concrete pads will be constructed as part of the project and the Community Mailboxes will be relocated to the final location by Canada Post**

WATERMAIN SHUTDOWNS

- A temporary watermain will be provided on the ground surface to maintain water service to each property, some short-term shutdowns will be required at certain times to make connections.
- Homeowners will be provided notice by door-hangers on your front door 48 hours prior to all scheduled watermain shutdowns.

TREE ASSESSMENT

- **The design of the project included a tree assessment completed by a certified arborist**
- **The assessment includes:**
 - Evaluation of tree health, size, and species
 - Recommendations for tree pruning
 - Recommendations for tree protection during construction; and
 - Identification of tree removal needs.

IDENTIFIED TREE REMOVALS

- **Tree removals are identified where:**
- The tree health is identified as poor and removal is coordinated with the project
- Conflict with the installation of new infrastructure is unavoidable
- **Tree removals are a joint decision between the arborist, consultant, and the Municipality.**
- **Municipal or shared trees will be removed as part of the project at no cost to the homeowner.**
- **Private trees may be identified as in poor health and remain the homeowners responsibility to maintain or remove.**

TREE PROTECTION

- **Tree protection commonly utilized during construction includes:**
- Tree protection fencing to keep machinery and construction material storage away from the trees and their root systems
- Trenchless service installation where required. Some sewer and water services may require trenchless installation in order to minimize root system damage
- Protection of tree root systems, through the placement of mulch and plywood during construction

TREE PRESERVATION DRAWING

PORTER SUBDIVISION WATERMAIN
REPLACEMENT AND ROAD
RECONSTRUCTION

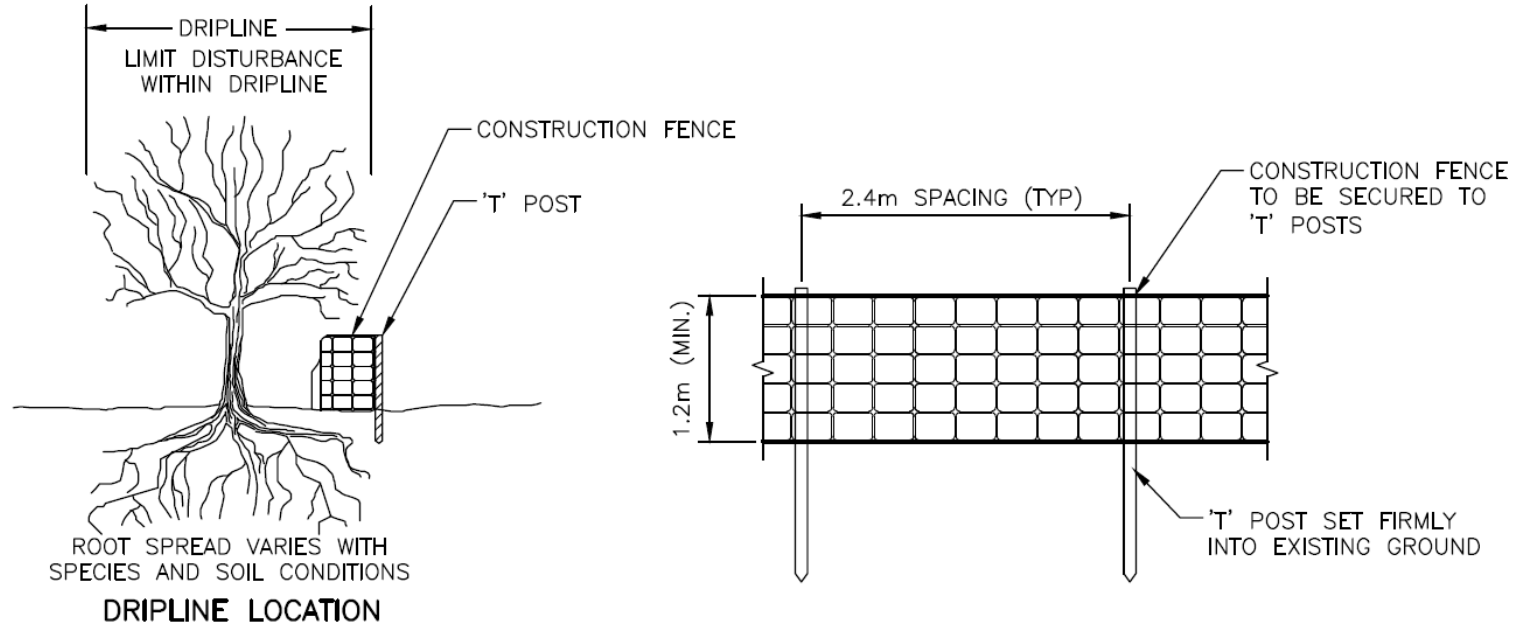

TREE PRESERVATION FENCING
(REF. OPSS 801.07.02)
NTS

(REFERENCE OPSD 220.010 FOR
PLACEMENT DETAILS WITHIN DRIPLINE)

TREE PRESERVATION EXAMPLES

PORTER SUBDIVISION WATERMAIN
REPLACEMENT AND ROAD
RECONSTRUCTION



NEXT STEPS

- **Construction of Phase 1 of the project is anticipated to commence July 2022**
- **Follow the project on the Municipality's website**
- **Homeowners are encouraged to share any special considerations or comments such as accessibility concerns or planned events to the contacts provided.**

MUNICIPALITY OF THAMES CENTRE

- Stay up to date on the Municipality website:

<https://thamescentre.on.ca/articles/2022-porters-subdivision-watermain-replacement-and-road-reconstruction-phase-1>

CONTACT INFORMATION

ENGINEERING CONSULTANT

Development Engineering (London) Limited

41 Adelaide St. N, Unit 71, London, ON, N6B 3P4

Josh Smith, P.Eng.

Project Manager

jsmith@deveng.net

519-672-8310 x113

Daniil Lobastov

Contract Administrator

dlobastov@deveng.net

519-672-8310 x139

MUNICIPALITY OF THAMES CENTRE

4305 Hamilton Road, Dorchester, ON, N0L 1G3

Jarrold Craven

Director of Public Works

jcraven@thamescentre.on.ca

519-268-7334 x245

Tanner Stanton

Engineering Technologist

tstanton@thamescentre.on.ca

519-268-7334 x235

THANK YOU



CONSULTING CIVIL ENGINEERS

